

**REFER TO PAGE 46 FOR PART DIMENSIONS**

NOTE: ALL MOUNTING DIMENSIONS ARE FOR REFERENCE ONLY. PLEASE VERIFY YOUR FUSE LAYOUT PRIOR TO FABRICATION.



**3517**

CAT. NO. 3517	
FUSE SIZE	L DIM.
5mm x 20mm	.910 (23.1)

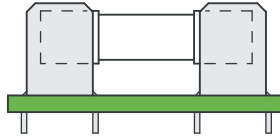

**FIGURE 1**

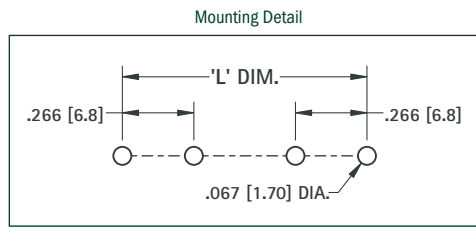

**3517**



**3518P**

CAT. NO. 3518P	
FUSE SIZE	L DIM.
5mm x 20mm	.910 (23.1)

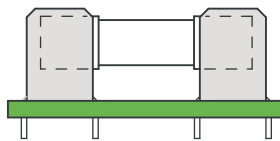

**FIGURE 2**

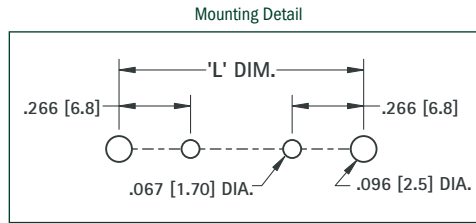

**3518P**



**3512**

CAT. NO. 3512	
FUSE SIZE	L DIM.
5mm x 20mm	.910 (23.1)

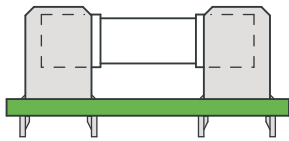

**FIGURE 3**

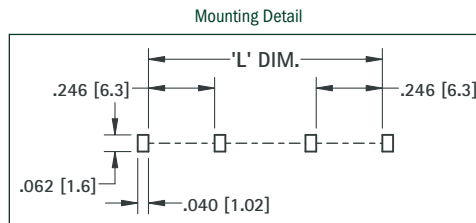

**3512**



**3512P**

CAT. NO. 3512P	
FUSE SIZE	L DIM.
5mm x 20mm	.910 (23.1)

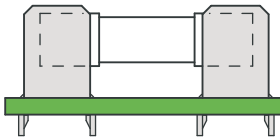

**FIGURE 4**

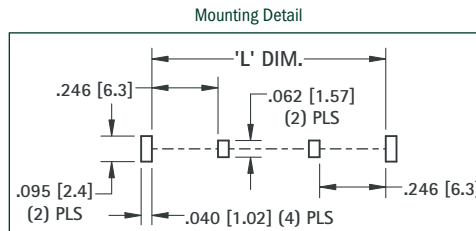

**3512P**



**3520**

CAT. NO. 3520	
FUSE SIZE	L DIM.
5mm x 20mm	.900 (22.9)

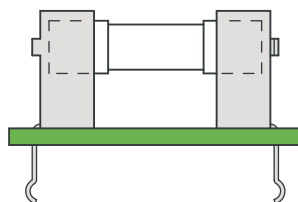

**FIGURE 5**

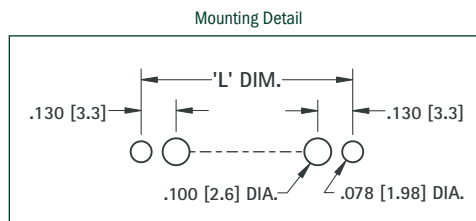

**3520**

**REFER TO PAGE 46 FOR PART DIMENSIONS**

NOTE: ALL MOUNTING DIMENSIONS ARE FOR REFERENCE ONLY. VERIFY YOUR FUSE LAYOUT PRIOR TO FABRICATION.



**3519**

CAT. NO. 3519	
FUSE SIZE	L DIM.
5mm x 20mm	.650 (16.5)

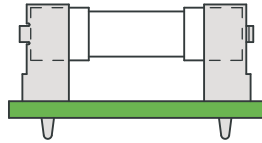

**FIGURE 6**

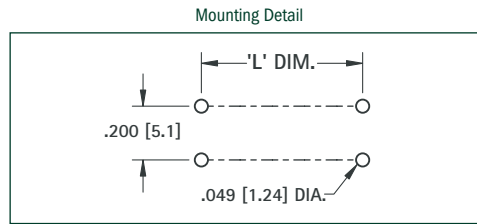

**3519**



**3521**

CAT. NO. 3521	
FUSE SIZE	L DIM.
2AG	.514 (13.1)
5mm x 20mm	.710 (18.1)

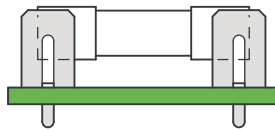

**FIGURE 7**

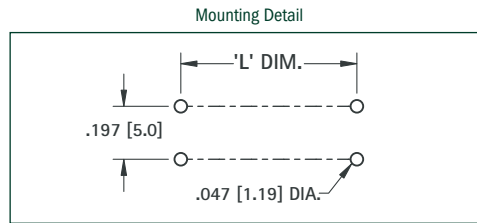

**3521**



**3561**

CAT. NO. 3561	
FUSE SIZE	L DIM.
2AG	.354 (9.0)
5mm x 20mm	.500 (12.7)



**FIGURE 8**

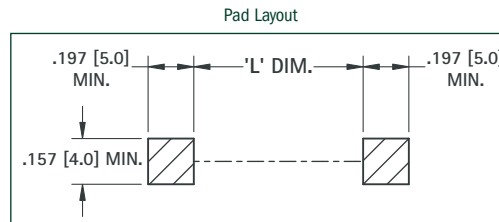

**3561**



**3562**

CAT. NO. 3562	
FUSE SIZE	L DIM.
5mm x 20mm	.820 (20.9)
3AG	

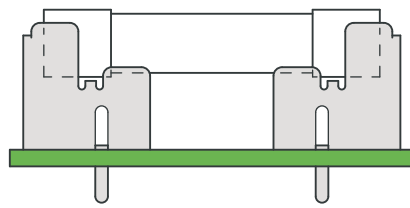

**3AG**

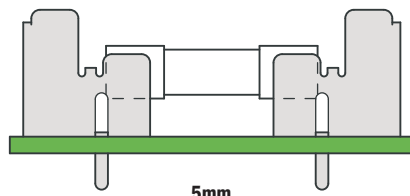

**5mm**

**FIGURE 9**

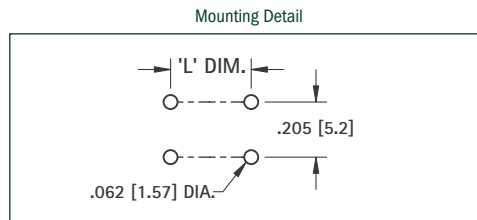

**3562**

**REFER TO PAGES 46 & 47 FOR PART DIMENSIONS**

NOTE: ALL MOUNTING DIMENSIONS ARE FOR REFERENCE ONLY. PLEASE VERIFY YOUR FUSE LAYOUT PRIOR TO FABRICATION.

**FIGURE 10**



**3565**

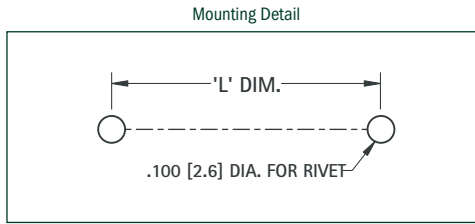
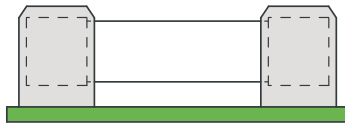

**3565**

CAT. NO. 3565		
DESIGNATION	FUSE SIZE	L DIM.
4AG	.281 (7.1) × 1.250 (31.8)	1.000 (25.4)

**FIGURE 11**



**3566**

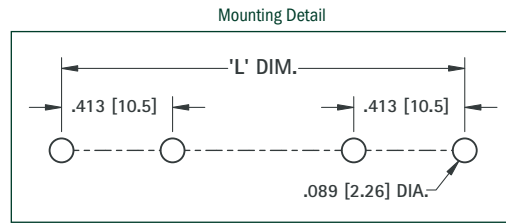
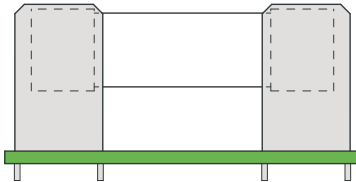

**3566**

CAT. NO. 3566		
DESIGNATION	FUSE SIZE	L DIM.
SM/SS	.406 (10.3) × 1.375 (34.9)	1.515 (38.5)
5AG	.406 (10.3) × 1.500 (38.1)	1.640 (41.7)

**FIGURE 12**



**3529**

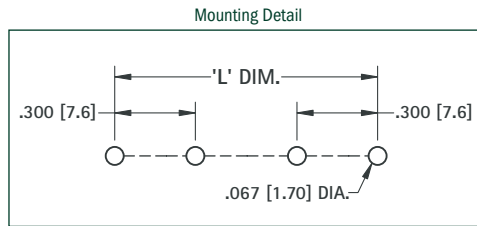
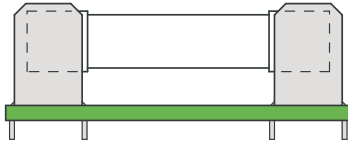

**3514**

CAT. NO. 3510, 3511, 3513, 3514, 3529		
DESIGNATION	FUSE SIZE	L DIM.
1AG	.250 (6.4) × .625 (15.9)	.750 (19.1)
7AG	.250 (6.4) × .875 (22.2)	1.000 (25.4)
8AG	.250 (6.4) × 1.000 (25.4)	1.125 (28.6)
3AG	.250 (6.4) × 1.250 (31.8)	1.375 (34.9)

**FIGURE 13**



**3516P**

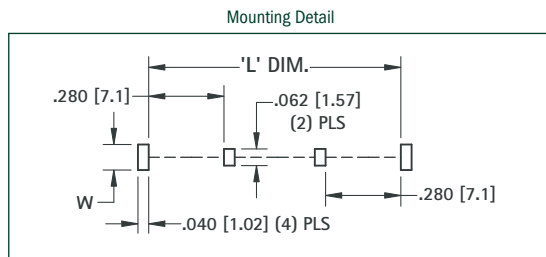
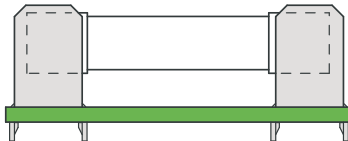

**3515**

CAT. NO. 3515, 3515P, 3516P		
DESIGNATION	FUSE SIZE	L DIM.
1AG	.250 (6.4) × .625 (15.9)	.735 (18.7)
7AG	.250 (6.4) × .875 (22.2)	.985 (25.0)
8AG	.250 (6.4) × 1.000 (25.4)	1.100 (28.0)
3AG	.250 (6.4) × 1.250 (31.8)	1.360 (34.6)

ORIENTATION LEGS	
CAT. NO.	W
<b>3515</b>	.062 (1.57)
<b>3515P</b>	.095 (2.4)
<b>3516P</b>	.122 (3.1)

# REFER TO PAGE 47 FOR PART DIMENSIONS

NOTE: ALL MOUNTING DIMENSIONS ARE FOR REFERENCE ONLY. VERIFY YOUR FUSE LAYOUT PRIOR TO FABRICATION.



3530

**FIGURE 14**  
FOR THRU HOLE MOUNT APPLICATIONS

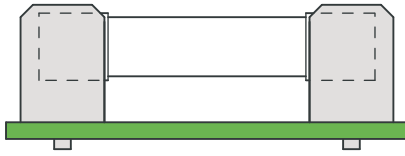

3530

**FOR CAT. NO. 3530**

DESIGNATION	FUSE SIZE	L DIM.
1AG	.250 (6.4) × .625 (15.9)	.450 (11.4)
7AG	.250 (6.4) × .875 (22.2)	.700 (17.8)
8AG	.250 (6.4) × 1.000 (25.4)	.825 (21.0)
3AG	.250 (6.4) × 1.250 (31.8)	1.075 (27.3)

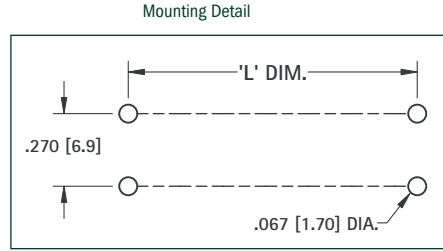

3570

**FIGURE 15**  
FOR RIVET MOUNT APPLICATIONS

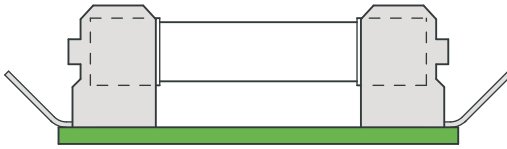

3535

**FOR CAT. NO. 3531, 3533, 3535, 3570**

DESIGNATION	FUSE SIZE	L DIM.
1AG	.250 (6.4) × .625 (15.9)	.450 (11.4)
7AG	.250 (6.4) × .875 (22.2)	.700 (17.8)
8AG	.250 (6.4) × 1.000 (25.4)	.825 (21.0)
3AG	.250 (6.4) × 1.250 (31.8)	1.075 (27.3)

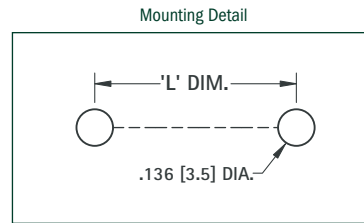

4247

**FIGURE 16**  
FOR SURFACE MOUNT APPLICATIONS



3533

**FOR CAT. NO. 3531, 3533, 3535, 3570**

DESIGNATION	FUSE SIZE	L DIM.
1AG	.250 (6.4) × .625 (15.9)	.120 (3.0)
7AG	.250 (6.4) × .875 (22.2)	.365 (9.3)
8AG	.250 (6.4) × 1.000 (25.4)	.490 (12.4)
3AG	.250 (6.4) × 1.250 (31.8)	.740 (18.8)

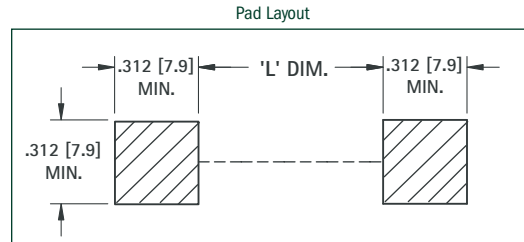

3532

**FIGURE 17**  
FOR SURFACE MOUNT APPLICATIONS



3567

**FOR CAT. NO. 3532, 3567**

DESIGNATION	FUSE SIZE	L DIM.
1AG	.250 (6.4) × .625 (15.9)	.195 (5.0)
7AG	.250 (6.4) × .875 (22.2)	.445 (11.3)
8AG	.250 (6.4) × 1.000 (25.4)	.570 (14.5)
3AG	.250 (6.4) × 1.250 (31.8)	.820 (20.8)

