

Silicon PNP Power Transistors

2SA715

DESCRIPTION

- With TO-126 package
- Complement to type 2SC1162

APPLICATIONS

- Low frequency power amplifier applications

PINNING

PIN	DESCRIPTION
1	Emitter
2	Collector;connected to mounting base
3	Base

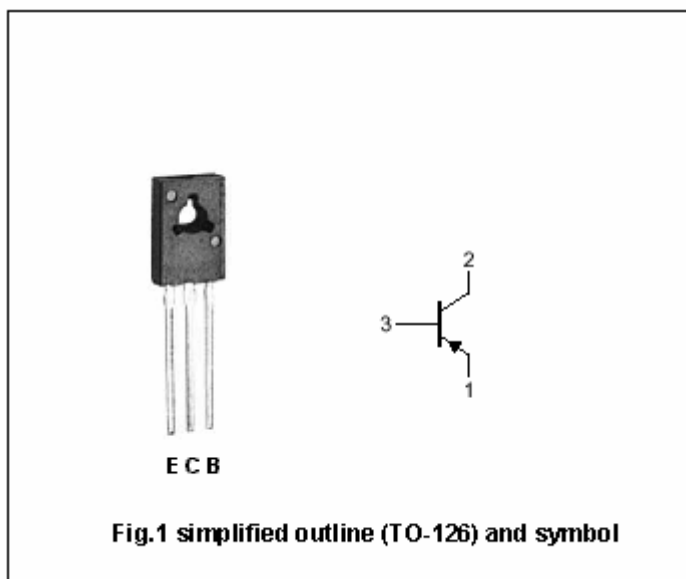

Absolute Maximum Ratings (Ta=25℃)

SYMBOL	PARAMETER	CONDITIONS	VALUE	UNIT
V_{CBO}	Collector-base voltage	Open emitter	-35	V
V_{CEO}	Collector-emitter voltage	Open base	-35	V
V_{EBO}	Emitter-base voltage	Open collector	-5	V
I_C	Collector current (DC)		-2.5	A
I_{CM}	Collector current-Peak		-3	A
P_C	Collector power dissipation	$T_a=25^{\circ}\text{C}$	0.75	W
		$T_C=25^{\circ}\text{C}$	10	
T_j	Junction temperature		150	℃
T_{stg}	Storage temperature		-55~150	℃

Silicon PNP Power Transistors

2SA715

CHARACTERISTICS

T_j=25°C unless otherwise specified

SYMBOL	PARAMETER	CONDITIONS	MIN	TYP.	MAX	UNIT
V _{(BR)CEO}	Collector-emitter breakdown voltage	I _C =-10mA; R _{BE} =∞	-35			V
V _{(BR)CBO}	Collector-base breakdown voltage	I _C =-1mA; I _E =0	-35			V
V _{(BR)EBO}	Emitter-base breakdown voltage	I _E =-1mA; I _C =0	-5			V
V _{CEsat}	Collector-emitter saturation voltage	I _C =-2.0A; I _B =-0.2A(Pulse test)		-0.5	-1.0	V
V _{BE}	Base-emitter voltage	I _C =-1.5A; V _{CE} =-2V(Pulse test)		-1.0	-1.5	V
I _{CBO}	Collector cut-off current	V _{CB} =-35V; I _E =0			-20	μA
h _{FE-1}	DC current gain	I _C =-0.5A; V _{CE} =-2V	60		320	
h _{FE-2}	DC current gain	I _C =-1.5A; V _{CE} =-2V(Pulse test)	20			
f _T	Transition frequency	I _C =-0.2A; V _{CE} =-2V(Pulse test)		160		MHz

◆ h_{FE-1} Classifications

B	C	D
60-120	100-200	160-320

Silicon PNP Power Transistors

2SA715

PACKAGE OUTLINE

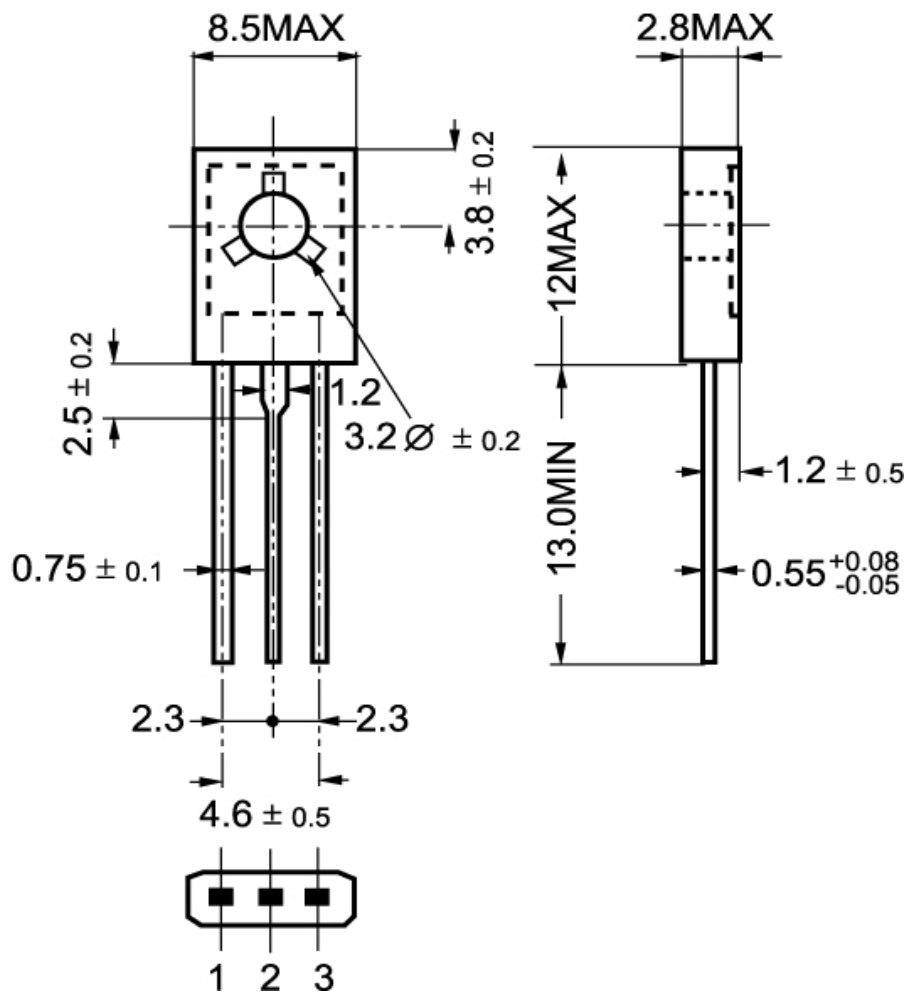

Fig.2 Outline dimensions

Silicon PNP Power Transistors

2SA715

